



**CUPA**PIZARRAS

The world leader in natural slate

---

**Natural Slate**

# INDEX

CUPA PIZARRAS.....	P. 3
NATURAL SLATE.....	P. 4
PRODUCTION PROCESS OF NATURAL SLATE.....	P. 6
ECOLOGY.....	P. 8
RANGE OF PRODUCTS.....	P. 11
SELECTIONS AND QUALITY.....	P. 12
HOW TO CHOOSE A HIGH QUALITY SLATE?.....	P. 14
CASE STUDIES.....	P. 16
THERMOSLATE® .....	P. 18
CUPACLAD® .....	P. 20
CUPA PIZARRAS SUPPORT.....	P. 22



Headquarters of CUPA PIZARRAS  
Sobradelo de Valdeorras, Spain

## CUPA PIZARRAS, THE WORLD LEADER IN NATURAL SLATE

CUPA PIZARRAS leads the world in slate production. Our 16 quarries and 22 processing plants combine the latest technology with our traditional know-how and craftsmanship.



### LEADER

One out of three slates for roofing and covering facades in the world have our name written on them. Thousands of architects, professional roofers and private home owners rely on our natural slate to make all of their projects a reality.



### WORLDWIDE

More than 98% of our production is exported to more than 60 countries throughout five continents. We also have branch offices in France, the United Kingdom, the three Benelux countries, Denmark and the United States of America.



### NATURAL SLATE

We have been producing and commercializing slate since 1892. We have over 125 years of experience in this area and a team of over 1500 associates made up of experts who are passionate about natural slate.



One-of-a-kind

Each slate is unique. Its texture tells us the story. Created by all the natural forces and made up of many different minerals. No other artificial alternatives could compare with a product which has been molded by nature for over 500 million years.



Durability

With a durability of over 100 years, natural slate is the most resistant material used for roofing. Unlike the artificial products, the color and the properties of slate stay, unalterable, through time with no need of maintenance.



Sustainability

By being 100% natural, slate is the roofing material with less environmental impact. Each slate is handcrafted by our skilled splitting craftsmen with no chemical products or additional treatments added.



Performance

Slate is capable of enduring extreme temperatures, difficult snow formation, fire-resistance as well as being fully waterproof. Only natural slate guarantees a perfect performance in any weather condition.



Tradition

Slate has endured the test of time. Its unparalleled character and durability makes this material ideal to preserve the aesthetics appearance and personality of any architectural project.

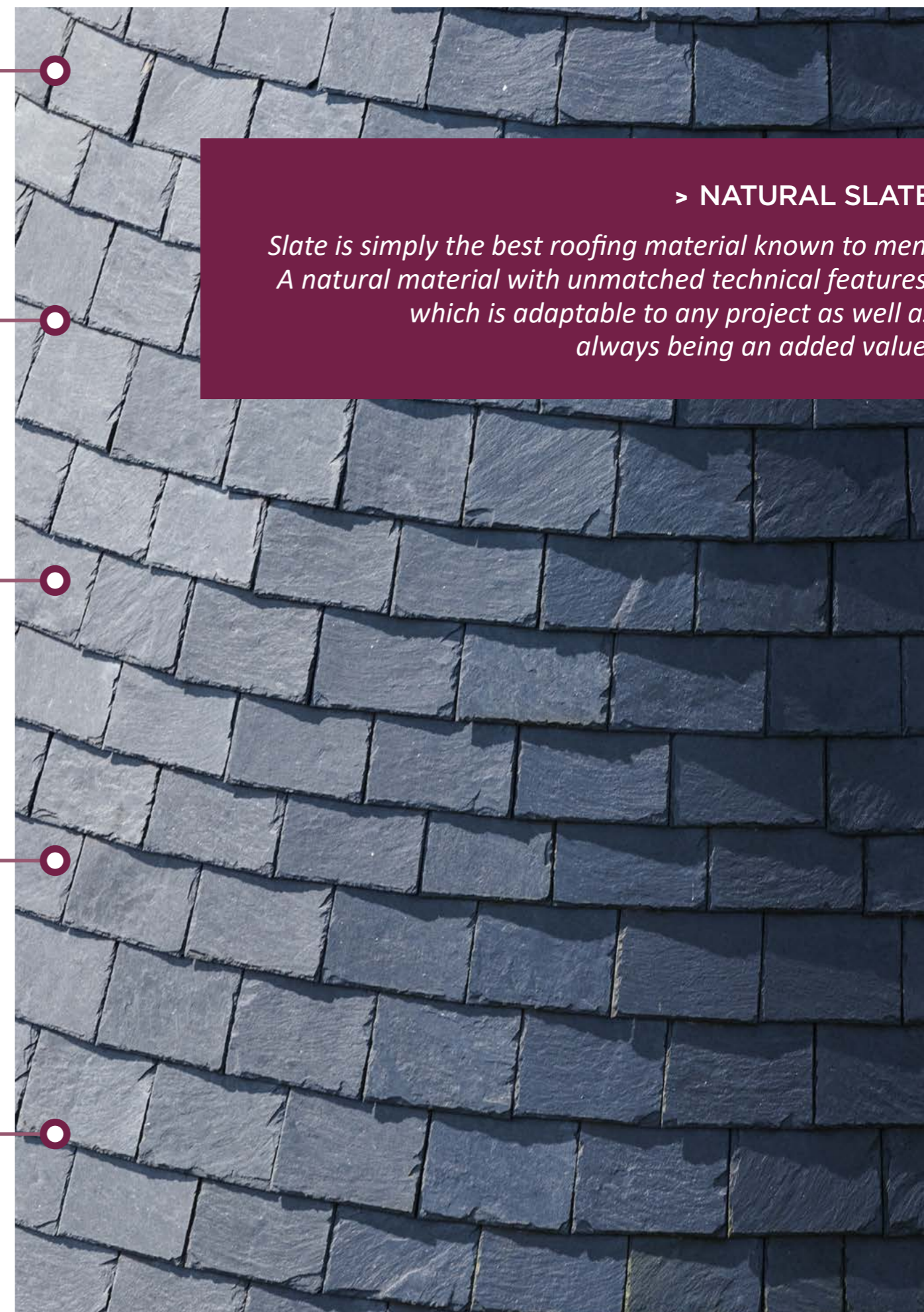

> NATURAL SLATE

*Slate is simply the best roofing material known to men. A natural material with unmatched technical features, which is adaptable to any project as well as always being an added value.*

# PRODUCTION PROCESS OF NATURAL SLATE

The production process of slate is completely natural:

combining the highest technology with the traditional know how by our skilled handcrafters.

CUPA PIZARRAS  
production figures

35 trucks/day 

180.000 tons/year 

200 roofs/day 



1

## 1. GEOLOGICAL STUDIES

Before initiating the extraction, studies are made on the potential of the deposit reserves by taking a sounding. This is done to identify the quality of the slate.

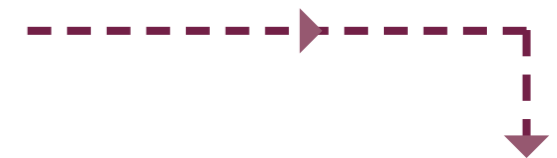

2

## 2. EXTRACTION

Slate is extracted in huge blocks which are later diamond wire sawed into smaller blocks. These smaller blocks are transported by trucks to the transformation warehouse factory located within the quarry.



3

## 3. TRANSFORMATION

Once in the transformation warehouse factory, our production team examines each slate block and classifies it by their potential.

- **SAWED OFF.** These blocks are sawed into different sizes depending on the dimensions of the slate which will be produced.
- **HAND CUT.** The skilled "splitters" exfoliate the slate into thin layers. This handcrafted and meticulous technique allows the finished product to be of great quality.
- **BEVELED.** The edges of each piece are beveled by a machine in order to make them into the exact size which has been required and thus giving it a characteristic finish.



4

## 4. SELECTION

Each slate is inspected by a manual selection process carried out by our quality control department. Both technical and aesthetic control criteria are taken into account here.

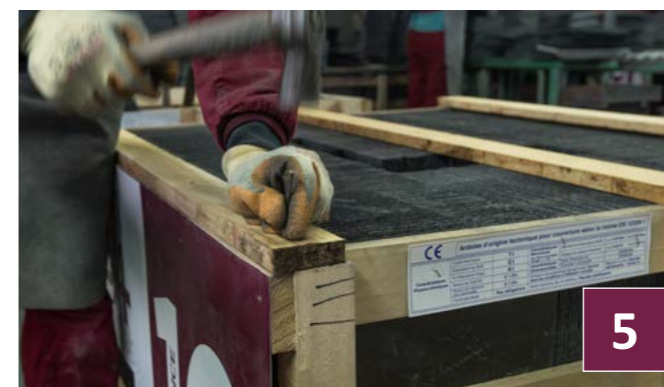

5

## 5. PACKAGING

The finished slate pieces are counted and packaged in wooden crates. As part of our tracking process, each crate is labeled with all of the technical information of the slate.

CUPA PIZARRAS proudly offers a natural product in the market with the least environmental impact given by other alternatives for roofing and building facades.

The life-cycle analysis, which allows an analysis of environmental impact of a product in a global scale, confirms that natural slate is the best ecological option for any architectural project\*.



**WATER CONSUMPTION**

**ENERGY CONSUMPTION**

**AIR POLLUTION**

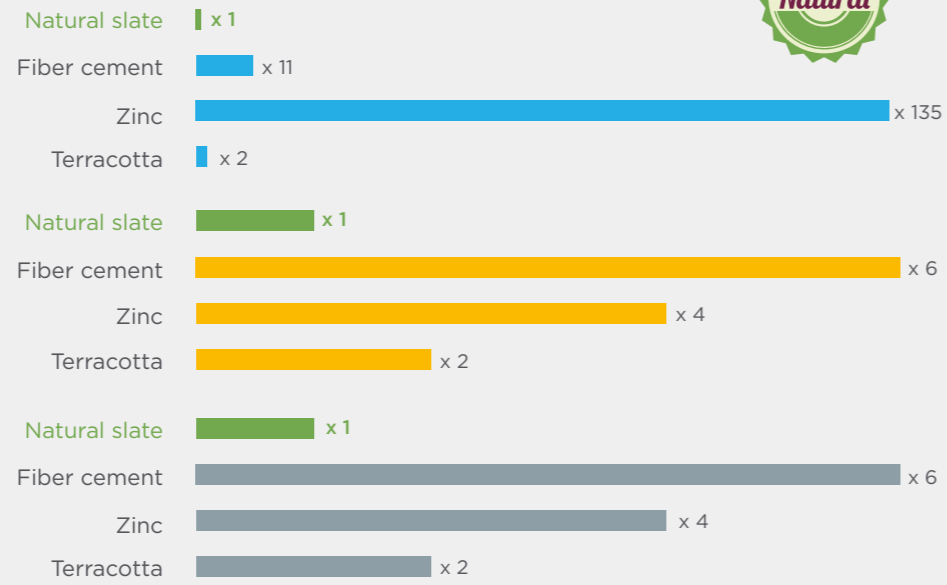

\*Life-cycle assessment, studies all the stages of a product's life from production to recycling. Data obtained from the open French database INIES, published in September 2014 and available publicly on the following link: (<http://www.base-inies.fr/inies/Consultation.aspx>)  
Data calculated for 1 square meter/year. Sources for each project are as follow: Natural slate (<http://goo.gl/K5ILx8>); Fibre cement (<http://goo.gl/OSjeV5>); Zinc (<http://goo.gl/EgWh6g>); Terracotta (<http://goo.gl/Y03c9U>). CUPA PIZARRAS is not responsible for the accuracy of the data provided by the open French database INIES.



OUR ENVIRONMENTAL POLICY

Our environmental commitment becomes evident through the optimization of the production process as well as the creation of innovative solutions focused on the reduction of energy consumption and carbon emissions.



CUPA PIZARRAS counts with the ISO 14001 certification which reflects its plan to protect the environment.



CUPA PIZARRAS is fully committed to improving the production process. This is done through the environmental statement for the construction products.



FDES are standardized documents which analyze the life-cycle of our products and also certify their low environmental impact.



The production process of natural slate requires a certain level of humidity. In order to reduce the consumption of water, closed circuits have been created and thus allowing the reuse of it.



Our rehabilitation actions of the quarries by means of hydro seeding autochthonous plants secure the recovery of the local flora and wildlife.



More than 60% of the production is transported by ship. This means of transportation is cleaner and more efficient and thus further reducing carbon emissions.

*Choose CUPA PIZARRAS natural slate, the sustainable roofing product.*



## OUR NATURAL SLATE RANGE: COVERING THE WORLD

Our slate covers more than 200 roofs per day, in every corner of the globe.

CUPA PIZARRAS natural slate is the product of choice for thousands of architects and roofers, and covers some of the most iconic buildings around the world.



## WE OFFER THE MOST COMPLETE RANGE OF PRODUCTS

CUPA PIZARRAS has been producing the most complete range of natural slate for roofing and facade since 1892.

### MODELS



\* Rectangular is the most common model in the International Market.

### SIZES

From 27 x 18 to 60 x 30 cm\*.

\* CUPA PIZARRAS produces more than 40.000 combinations of natural slate models, sizes and shapes.

### OUR SLATE RANGE FOR THE INTERNATIONAL MARKET



\* CUPA PIZARRAS promotes 4 of its 16 natural slates for the International Market.

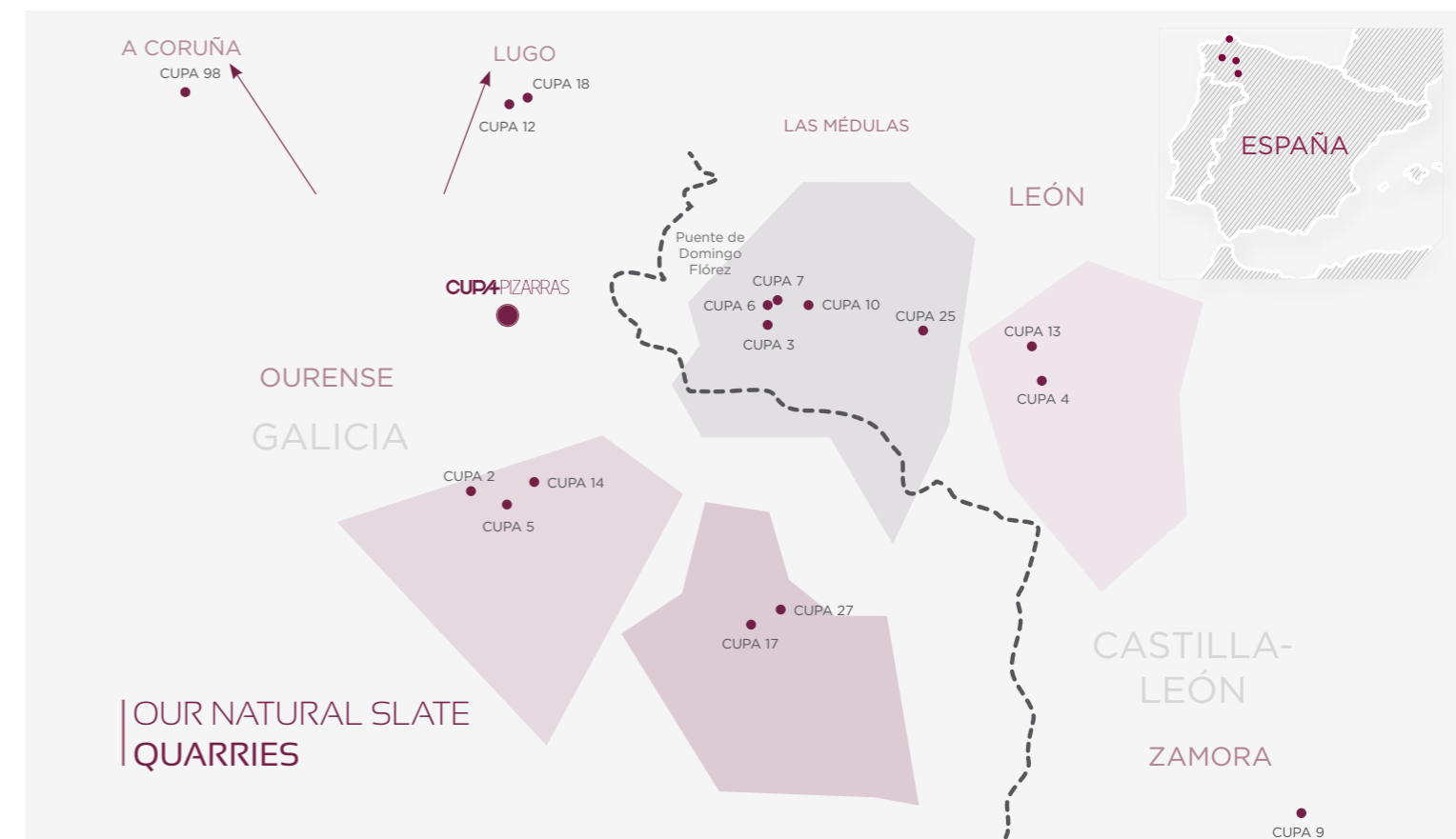

SELECTIONS

Throughout the manual selection process, the slate is classified in three different selections:



**SELECTION EXCELLENCE**

This is an extraordinary rigorous classification process which only pieces with high flatness and very regular thickness could pass.

This is considered to be the best natural slate produced in the world. Moreover, it is ideal for projects where a homogenous result for a perfect roof is demanded.

**SELECTION ARDOISIER**

It's characterized by its high quality and only admitting slight differences in the flatness and thickness of the piece.

These are slate pieces chosen by expert installers who are capable of fitting the product to make a homogenous roof.

**SELECTION HEAVY**

This is made up of slate with high thickness, over 7 millimeters (1/4" – 3/8").

Exceptional durability in any circumstance or weather conditions.

QUALITY

CUPA PIZARRAS has been pioneer in establishing the control, analysis and selection systems of natural slate since 1892.

An exhaustive control throughout the entire process allows a range of natural slate which exceeds in all of the quality standards in an international level.



PRODUCT TRACEABILITY

CUPA PIZARRAS has a one-of-a-kind integral system of quality control which permits to identify the origin, typology, technical facts and the date of the production of each of the natural slate.

Our product traceability is implemented with a unique barcode that is part of the slate throughout the whole production process.

CONSERVE ESTA ETIQUETA | KEEP THIS LABEL | ETIQUETTE À CONSERVER

**CUPA 10 EXCELLENCE**

ORIGEN   ORIGIN   ORIGINE <b>LAS ARCAS</b> S. PEDRO DE TRONES León	FORMATO   FORMAT <b>32x22</b> CON agujeros RECTANGULAR Normal	PIEZAS   UNITS   PIÈCES <b>1.950</b> ORIGEN TECTÓNICO
--	---	---

EP. NOMINALE | N. THICKNESS | 7,65 (L) | CE00 | 003 NF: 5278 REVISION 4 | ATG/H 571

**CUPA PIZARRAS** 1001276549 | 13/11/2017 **CUPA PIZARRAS.com**

Number of pieces per pallet

Barcode: traceability

This product traceability allows the slate to be monitored all through its process, from the quarry to the customer. This guarantees our **distinctive value and quality**.

## HOW TO CHOOSE A HIGH QUALITY SLATE?

A high quality natural slate is an unbeatable product for any project.

However, products, which vary in composition and quality and therefore giving it a very diverse performance, are being sold in the market. Necessary conditions needed for a high quality slate:



### 1. THE QUARRY'S REPUTATION

The slate characteristics depend on where it has been extracted. This is why it is imperative to validate the reputation from both the quarry and the company which produces it.

► *CUPA PIZARRAS has been producing natural slate since 1892. We are the number one producer, worldwide of natural slate. The prestige and reputation of our quarries has been confirmed thus making us leader in the sector.*



### 2. TECTONIC SLATE

Not all slates are all alike nor do they offer the same guarantees. Slate produced in Spain, unlike slate from other parts of the world, is of tectonic origin. Recognized worldwide for its performance.

► *All CUPA PIZARRAS SLATE is extracted from the best quarries in Galicia and in Castilla y León, Spain. Here we have the biggest tectonics natural slate reserves in the world.*



### 3. RECENT RESEARCH AND CERTIFICATIONS

It is vital to demand updated documentation from the producer which demonstrates the performance of the natural slate. Producers shall draw up declaration of performance in accordance with its identification: T1, A1, S1 and W1.

► *All natural slate produced in CUPA PIZARRAS has an updated declaration of performance available and revised constantly by the most prestigious international certifications.*

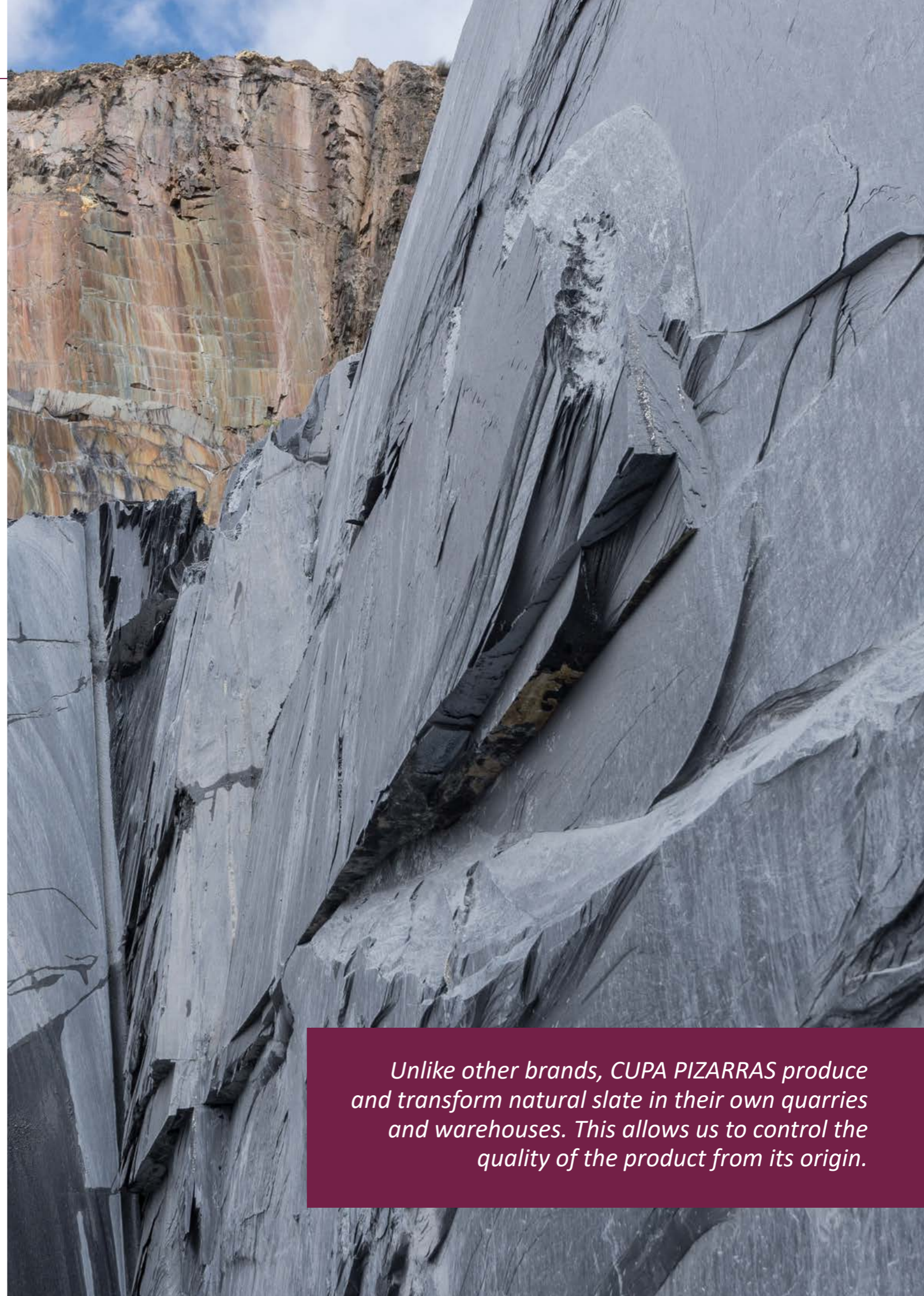

*Unlike other brands, CUPA PIZARRAS produce and transform natural slate in their own quarries and warehouses. This allows us to control the quality of the product from its origin.*





**CUPA 2 - BELGRAVE PLACE. SEAFORD, SUSSEX (UK)**

This luxury development is located in Seaford, East Sussex, and its design keeps many of the original architectural features of the area. Around 80,000 CUPA 12 slates were used for the project, giving an exclusive distinguishing touch. Project roofing contractors Simmons Roofing Ltd, are no strangers to natural slate and have laid 500,000 CUPA PIZARRAS slates over a period of four years on a number of projects.

“CUPA PIZARRAS slates are our first choice for any project due to their competitive price and consistent quality, which reduces the time we would normally spend sorting the slate before laying. It was our recommendation to the developers that CUPA 12 slates be used for Belgrave place.”  
Paul Farrier, Managing Director



**CUPA 7 PABLO PICASSO SCHOOL (FRANCE)**

Pablo Picasso School is located in Châlette-sur-Loing (Loiret, France). Between 2011 and 2014 this emblematic center of studies was demolished and built again. The new building was built following the principles of sustainable construction, seeking to limit the environmental impact. That’s why the architect Vincent Bourgoïn decided to install on

the new roof more than 3500 m<sup>2</sup> of CUPA 7 natural slates (size 40x22 rectangular format). An efficient and ecological material that maintains its inalterable properties over time without the need for maintenance. To complement this sustainable project, thermal solar panels, photovoltaic panels and a geothermal heating system was also been installed.

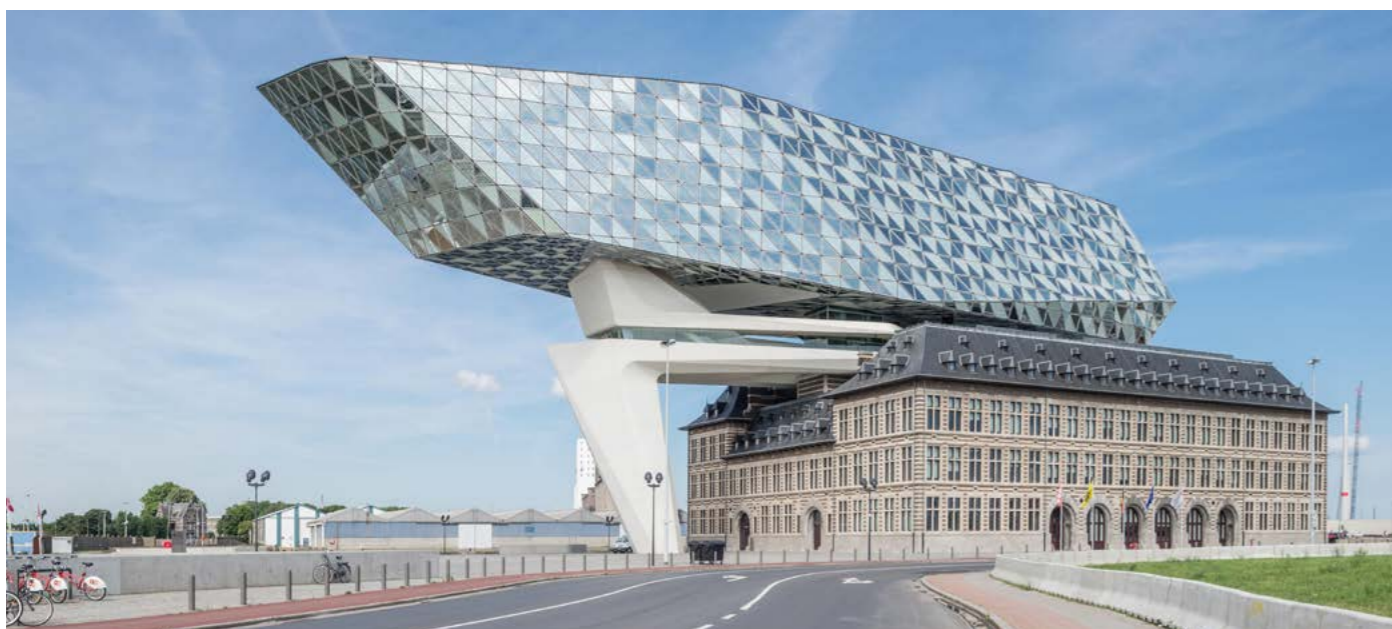

**CUPA 4 - ANTWERP PORT HOUSE (BELGIUM)**

The city of Antwerp can now boast about having such an emblematic building by architect Zaha Hadid! The spectacular “Havenhuis” dominates the port and reinforces the dynamic image of the city. This building is currently the symbol of the growth of the port of Antwerp. The architectural competition organized by the Flemish government’s department of architecture, together with the City

and Port had one rule: the original building had to be preserved. That is the reason why the great Anglo-Iraqi architect Zaha Hadid designed a project conserving the whole building but laying down a radically contemporary structure. The roof of the original building recalling the 16<sup>th</sup> century is now featuring CUPA 4 slates, quarried from Armadilla (in Spain) which highlights the beauty and elegance of any roof.



**CUPA 12 - COPENHAGEN CENTRAL RAILWAY STATION (DENMARK)**

It is the main train station in Copenhagen and the largest one in Denmark. It was built in 1911, although the building we know today is actually the third one built in the same location (the previous structures were made of wood).

Nowadays it has an interesting combination of styles. For this renovation project, the roofers had to install more than 4500 m<sup>2</sup> of CUPA 12 slates (size 60x30 in rectangular format)!

THERMOSLATE thermal panel system is one of a kind in the market which uses natural slate to transform solar light into energy. This is later used for heating, hot water or to heat swimming pools.

Because of its modular design, THERMOSLATE is integrated in a quick and easy way to create a natural slate roof.



**Efficient**

Up to 2/3 of annual needs for hot water



**Compatible**

With any storage and distribution system



**Energy saver**

For domestic hot water and pool heating



**Invisible**

Full integration into any roof or cladding

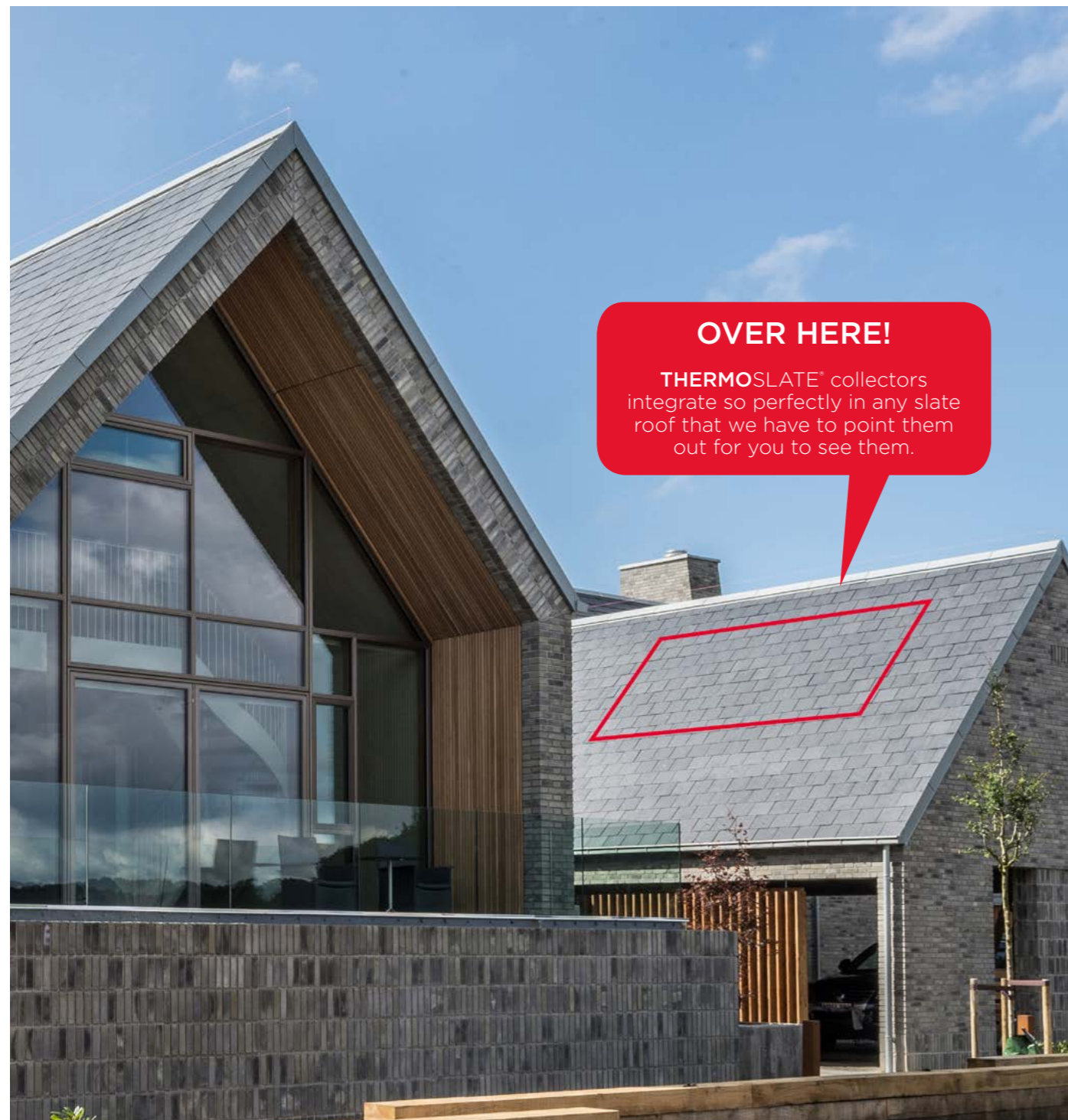

CUTTING-EDGE TECHNOLOGY IN YOUR NATURAL SLATE ROOF



**Light and robust**

Weighing just 44 US pounds, THERMOSLATE® is highly robust. This solar collector has been developed to be installed on any construction system.



**100% Waterproof**

A specific waterproofing kit certified by the CSTB, assures the total evacuation of water on the integration areas on slopes of over 3/12 pitch.



**Inspired by nature**

The veins on the backs of tree leaves inspire the most efficient known energy absorption and fluid distribution system, which the THERMOSLATE® collector incorporate.



**Efficiency and safety**

Maximum energy efficiency with a maximum operating temperature of 203° F, thanks to the properties of natural slate.

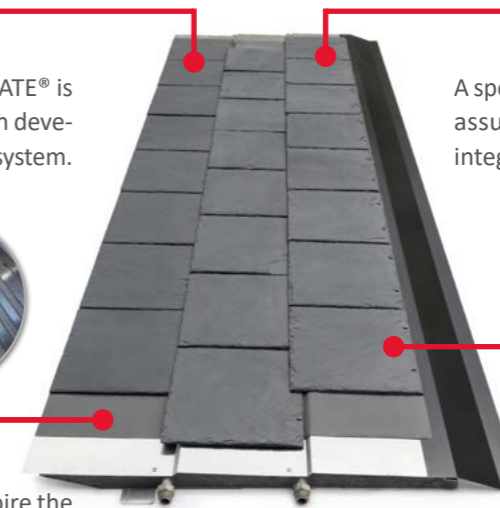

DIFFERENT SYSTEMS FOR A SEAMLESS INTEGRATION

1. System with nail



2. System with hook



3. Technical solar floor

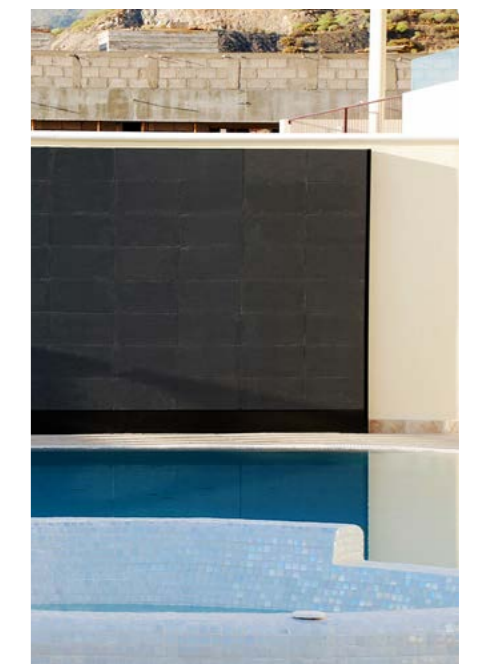

CERTIFIED QUALITY



The new system CUPACLAD® has revolutionized slate installation on a facade. This system was developed with the cooperation from Danish architects and installers.

The use of high durability tectonic slate, innovative fastening, and the efficiency of the rain screen cladding make CUPACLAD® an extremely competitive and sustainable alternative for cladding any facade.

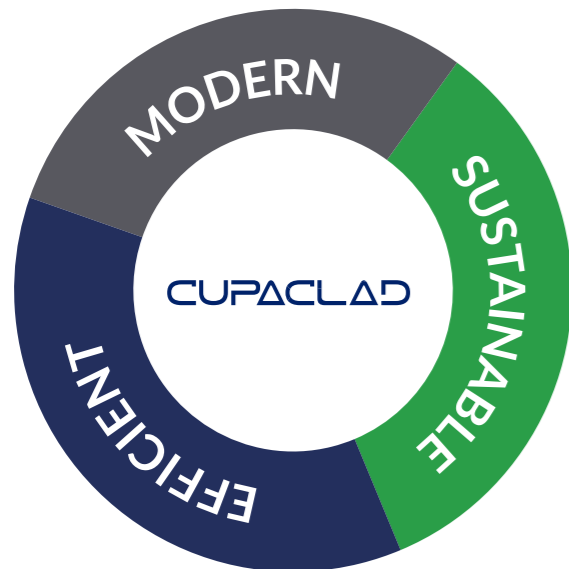

- Environmentally friendly and sustainable.
- Efficient as a ventilated cladding.
- Complementary to external insulation systems.
- Highly durable.
- Maintenance free.
- Quick and easy to install.
- Modern, Contemporary design.
- Lightweight and versatile: new and renovation projects



**SERIES 101**

CUPACLAD is characterized by the fastening system. These fasteners ensure an optimal installation on the facade while being completely invisible. The CUPACLAD 101 series system enhance the aesthetic of any wall or surface where installed.

CUPACLAD 101 *Logic* | Simple and balanced



CUPACLAD 101 *Random* | Dynamic and creative



CUPACLAD 101 *Parallel* | Uniform and regular

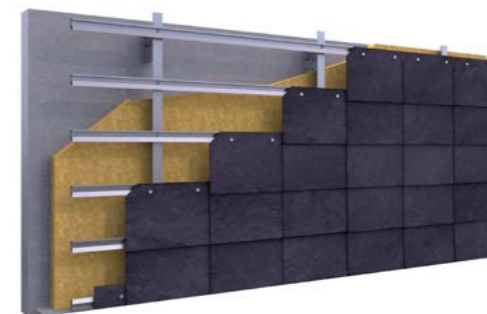

**SERIES 201**

Series 201 uses special visible stainless steel fasteners which combined with the texture of the natural slate gives this cladding a touch of trendiness.

CUPACLAD 201 *Vanguard* | Modern and efficient

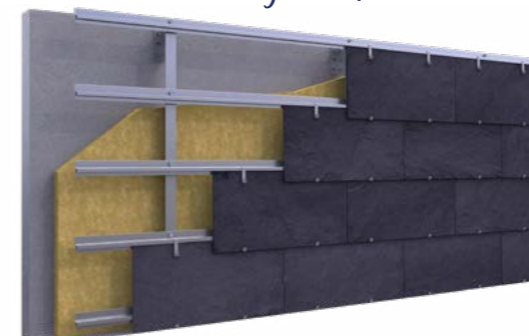

## CUPA PIZARRAS SUPPORT

Our pledge to high quality of all of our products has earned us the trust of thousands of architects, installers and clients. We are the world leader of natural slate thanks to you, our client.

More than 1500 professionals make up our team and we are committed to give you the best service available.



### CUPAPIZARRAS

Our office could be contacted via telephone or email. Do not hesitate to contact us.

- A Medua s/n (Sobrado de Valdeorras)
- Email: [info@cupapizarras.com](mailto:info@cupapizarras.com)
- Phone: +34 988 335 410
- Fax: +34 988 335 599



### CUPAPIZARRAS.com

This website is updated daily to ensure you can receive all of our newest information on our products anytime, anywhere.

- Download center
- Area for professionals
- News center
- Our projects



### Social Media

Our goal is to provide helpful information and listen, learn and engage with our clients. If you have questions, we're here to help with that too.

- Twitter: [@CUPAPIZARRAS\\_en](https://twitter.com/CUPAPIZARRAS_en)
- Facebook: [/CUPAPIZARRAS](https://www.facebook.com/CUPAPIZARRAS)
- LinkedIn: [/company/cupa-pizarras](https://www.linkedin.com/company/cupa-pizarras)
- Other Social media: Pinterest, Google+, Instagram, Youtube

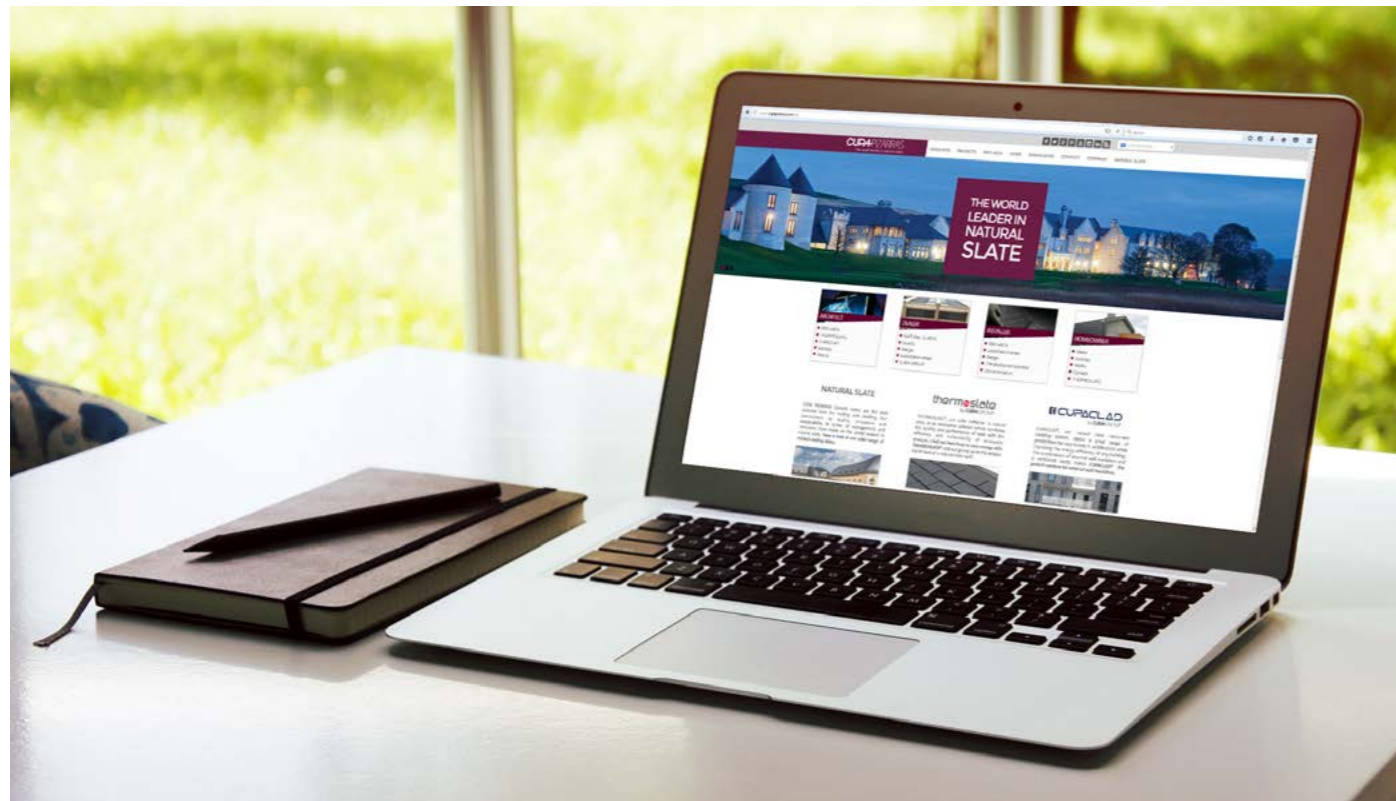

**CUPAPIZARRAS**  
The world leader in natural slate

### SUPPORT FOR ARCHITECTS

• **Specifier department:** Our slate professionals are at the disposal of architects to organize meetings or visits to our quarries, launch new products and support the entire specification process.

• **Technical support:** Our technical support team is made up of skilled professionals who are dedicated to each of our products: Natural Slate, CUPACLAD and THERMOSLATE. It offers the customer a consultancy service where all of your questions will be answered.

### SUPPORT FOR ROOFERS

• **Sales department:** our sales experts are happy to answer any questions and give you the best advice available during the whole process from the selection of the slate to the product installation. Don't hesitate to contact us, we are at your disposal.

• **Marketing tools:** Our marketing department has created documentation and materials ready for the installers. With a wide range of catalogues with technical information. We are ready to help you with any tool which may be needed.